

# POWER CONTROL CABINETS COMMERCIAL

Item no. 592.727, 592.727 001, 592.727 002,  
592.727 003, 592.727 004, 592.727 005



Actual product may vary

*Cost-effective cabinets for commercial and industrial-scale power control*

## DESCRIPTION OF FUNCTIONS

meteocontrol's standardized Monitoring Cabinets Commercial are compact and cost-effective solutions for centralized power control of PV and hybrid power plants.

- Customizable integration of blue'Log, MX-Modules, and other components based on system requirements.
- Pre-wired for a large selection of components to ensure quick and flexible installation.
- Reliable operation in harsh conditions, including exposure to rain, dirt, and moisture.
- A compact UPS for backup power provides essential reliability.

## TECHNICAL DATA

Dimensions (HxWxD)	615 x 415 x 230 mm
Housing	UV-resistant fiberglass reinforced plastic housing
Supply voltage	100 V AC to 230 V AC / 16 A
IP rating	IP 65
Operating temperature	-5°C...+30°C
Storage temperature	-15°C...+45°C
Weight	14.9 kg
Installation type	Wall installation

## INSTALLED EQUIPMENT

1x Power supply unit 24 V DC  $\pm 1\%$ , 2.5 A  
1x UPS 24 V DC, 2.5 A, 2x 0.8 Ah  
Top-hat rail socket (optional)

## PREWIRED EQUIPMENT

1x blue'Log

## OPTIONAL VARIANTS

Pre-wired for energy meter and switch: Item no. 592.727 001  
Pre-wired for energy meter and router: Item no. 592.727 002  
Pre-wired for energy meter, router, and switch: Item no. 592.727 003  
Pre-wired for power analyzer and switch: Item no. 592.727 004  
Pre-wired for power analyzer, router, and switch: Item no. 592.727 005  
If required, additional components can be implemented as a variant or special model

**COMMUNICATION INTERFACES**

Ethernet (Modbus TCP)  
 RS485 / 422 (Modbus RTU)  
 Digital  
 Analog

**WIRING DIAGRAM**

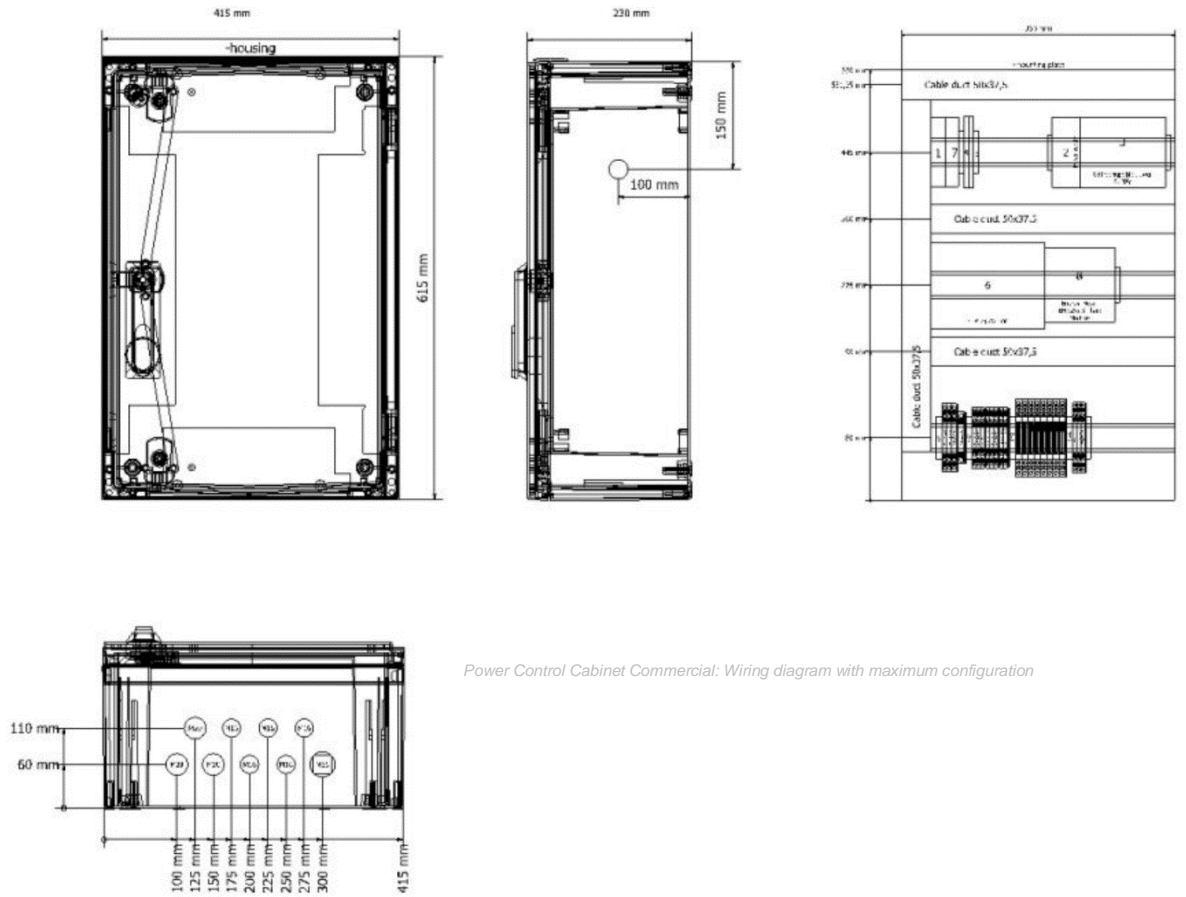

Power Control Cabinet Commercial: Wiring diagram with maximum configuration